

## YOUR NEW TV

### Rear Panel Jacks

Use the rear panel jacks to connect an A/V component that will be connected continuously, such as a VCR or a DVD player.

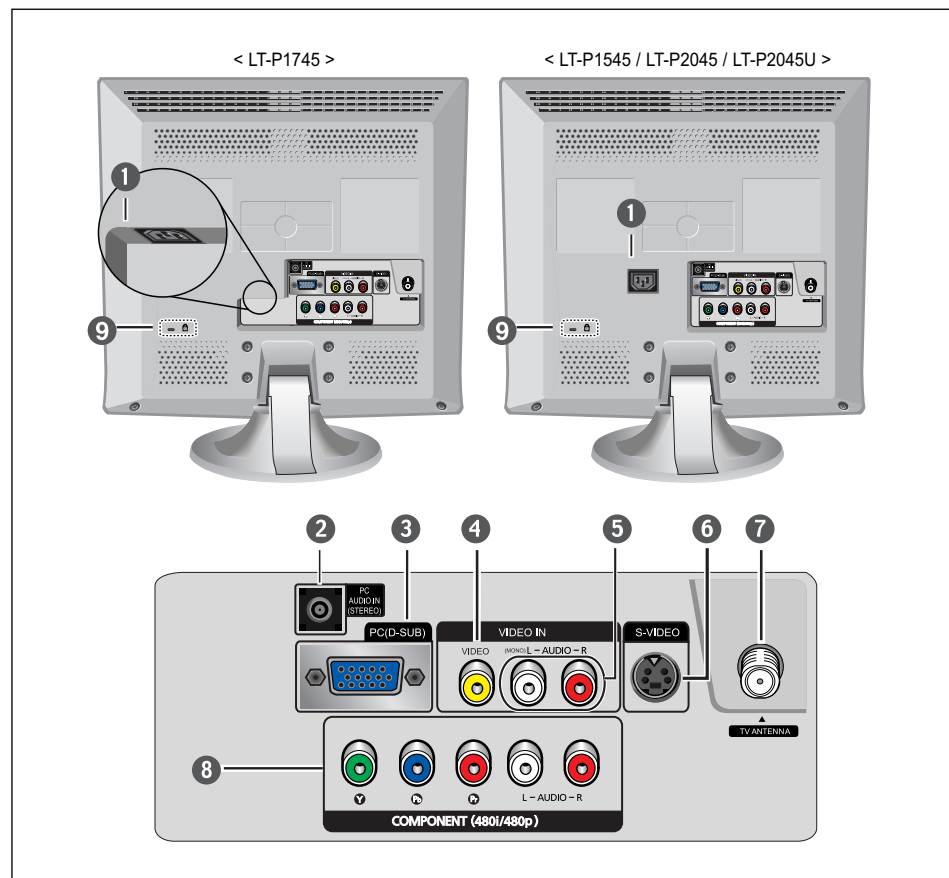

- |  |   |
|--|---|
| <p><b>1 POWER INPUT</b></p> <p><b>2 PC AUDIO IN (STEREO)</b></p> <p><b>3 PC VIDEO INPUT</b><br/>Connect to the video output port on your PC.</p> <p><b>4 VIDEO INPUT</b><br/>Connect a video signal from a camcorder or VCR.</p> <p><b>5 AUDIO INPUT</b><br/>Connect an audio signal(L/R) from a camcorder or VCR.</p> | <p><b>6 S-VIDEO INPUT</b><br/>Connect an S-Video signal from a camcorder or VCR.</p> <p><b>7 TV ANTENNA</b><br/>Connect to an antenna or to a cable TV system.</p> <p><b>8 COMPONENT</b><br/>Connect a component video/audio.</p> <p><b>9 KENSINGTON LOCK</b></p> |
|--|---|

# INSTALLATION

## Connecting a VCR

These instructions assume that you have already connected your TV to an antenna or a cable TV system .

Skip step 1 if you have not yet connected to an antenna or a cable system.

**1**

Unplug the cable or antenna from the back of the TV.

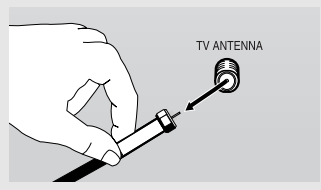

**2**

Connect the cable or antenna to the ANTENNA IN terminal on the back of the VCR.

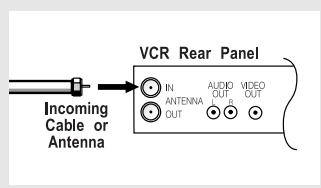

**3**

Connect a coaxial cable between the ANTENNA OUT terminal on the VCR and the antenna terminal on the TV.

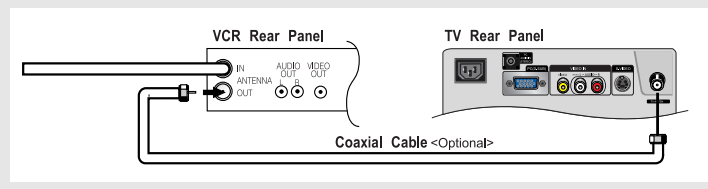

A coaxial cable is usually included with a VCR. (If not, check your local electronics store).

**4**

Connect a set of audio cables between the AUDIO OUT jacks on the VCR and the AUDIO jacks on the TV.

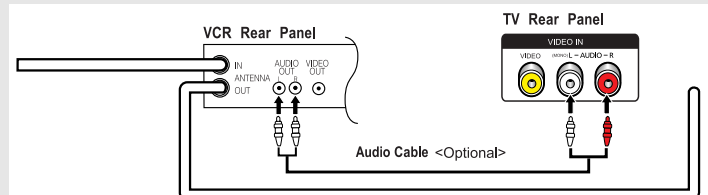

If you have a “mono” (non-stereo) VCR, use the Y-connector (not supplied) to hook up to the left and right audio input jacks of the TV.

If your VCR is stereo, you must connect two cables.

**5**

Connect a video cable between the VIDEO OUT jack on the VCR and the VIDEO jack on the TV.

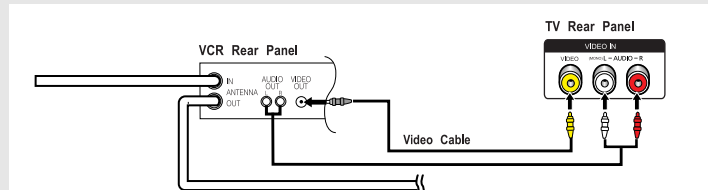

Follow the instructions in “Viewing a VCR or Camcorder Tape” to view your VCR tape.

\* Each external input source device has a different back panel configuration.

# INSTALLATION

## Connecting an S-VHS VCR

Your Samsung TV can be connected to an S-Video signal from an S-VHS VCR. (This connection delivers a better picture as compared to a standard VHS VCR.)

### 1

To begin, follow steps 1–3 in the previous section to connect the antenna or cable to your VCR and your TV.

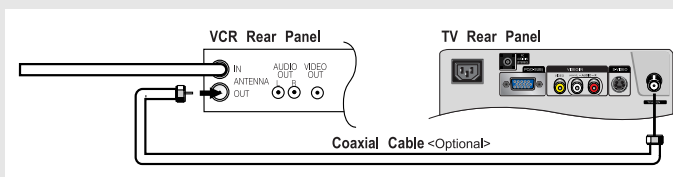

### 2

Connect a set of audio cables between the AUDIO OUT jacks on the VCR and the AUDIO INPUT jacks on the TV.

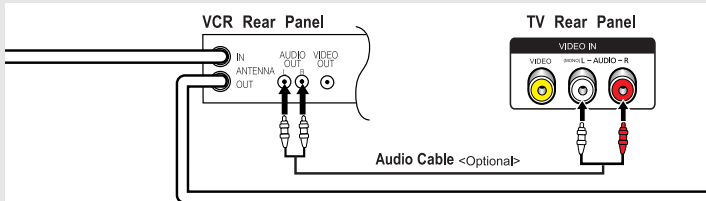

### 3

Connect an S-video cable between the S-VIDEO OUT jack on the VCR and the S-VIDEO INPUT jack on the TV.

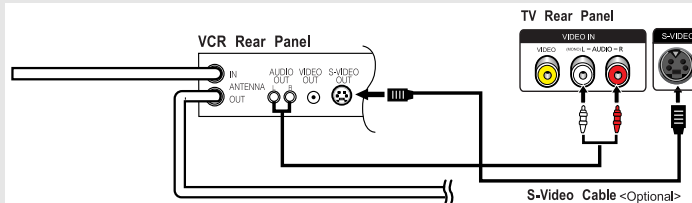

An S-video cable is usually included with an S-VHS VCR.

(If not, check your local electronics store.)

\* Each external input source device has a different back panel configuration.

## INSTALLATION

### Connecting a DVD Player

The rear panel jacks on your TV make it easy to connect a DVD player to your TV.

#### 1

Connect a set of audio cables between the L, R AUDIO INPUT jacks on the TV and the AUDIO OUT jacks on the DVD player.

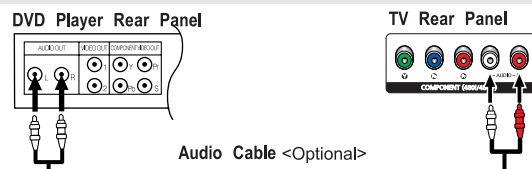

#### 2

Connect a video cable between the COMPONENT (Y, Pb, Pr) jacks on the TV and the Y, Pb, Pr jacks on the DVD player.

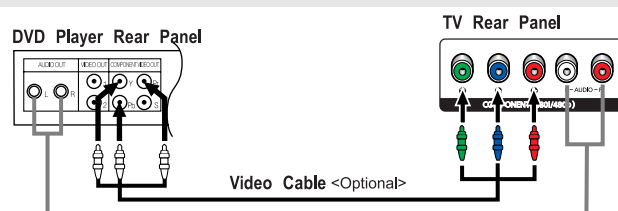

Note : For an explanation of Component video, see your DVD player owner's manual.  
The component terminal of this set only supports 480i/480p resolution.

\* Each external input source device has a different back panel configuration.

## APPENDIX

### Installing the Wall Mount Kit

Note : This installation is to be used when attaching the wall mount to a concrete wall.  
When attaching to other building materials, please contact your nearest dealer.

#### Components

Please use provided components or parts to install the Wall Mount Kit.

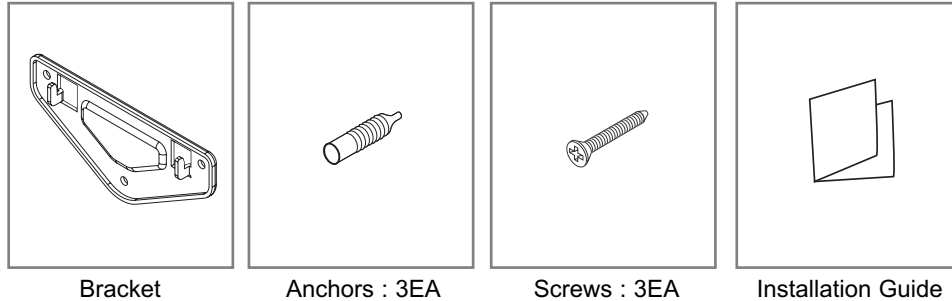

#### How to assemble the Wall Mount Kit

- 1 **1** Mark the location of hole on the wall using installation guide.
- 2 **2** Make over 35mm- depth- hole on the marked location using 5.0-diameter drill.
- 3 **3** Fix anchors on each hole on the wall.
- 4 **4** Connect bracket to the wall with screws after fitting anchors into the bracket holes.

Note : If the bracket is not firmly fixed to the wall, LCD TV can fall off.

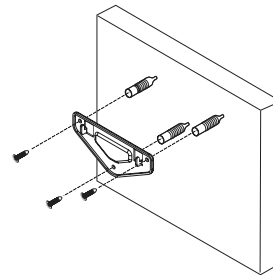

- 2 **2** After placing LCD TV on cushion or other soft material, turn over LCD TV in the direction of arrow while grabbing bottom of the stand.

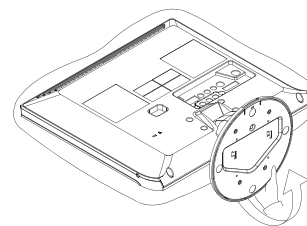

- 3 **3** When using LCD TV in stand-based form, place the product on a cushion or other soft materials. Then turn over stand following the arrow direction below only after pressing button on the connected part where LCD TV is attached to stand.  
(Turn over stand in the opposite direction after pressing button when using LCD TV in wall-mounted form as well.)  
(Only for 17-inch model)

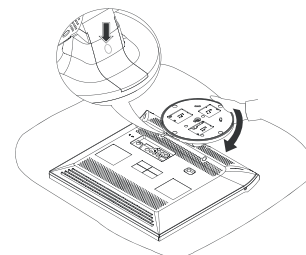

APPENDIX

## Installing the Wall Mount Kit

- 3** Adjust LCD TV to the hook on the bracket and move in the direction of the arrow(Left) so that LCD TV can be completely fixed to the bracket.

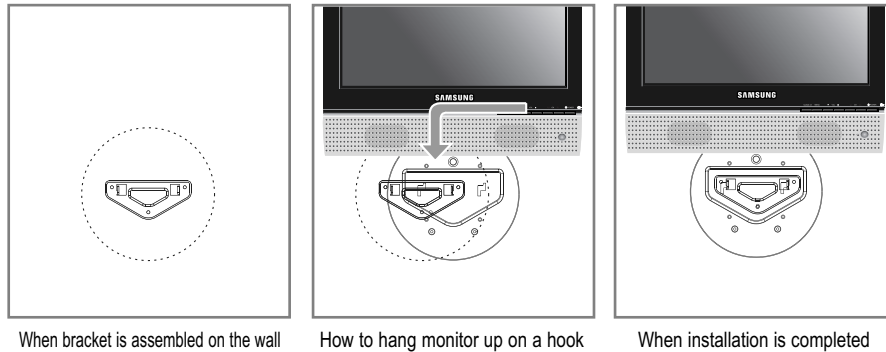

- 4** Remove Installation Guide after completing setup of LCD TV on the wall.
- 5** Push the LCD TV up and shift to the right to detach it from bracket.  
When moving or transferring to other areas, reverse No. 3 procedure so as to disconnect LCD TV with ease.

### How to adjust an angle

- (1) Angle adjustment section of general stand-besd LCD TV      (2) Angle abjstment section while converting the form (1->3, 3->1)      (3) Angle adjustment section of wall-mounted LCD TV

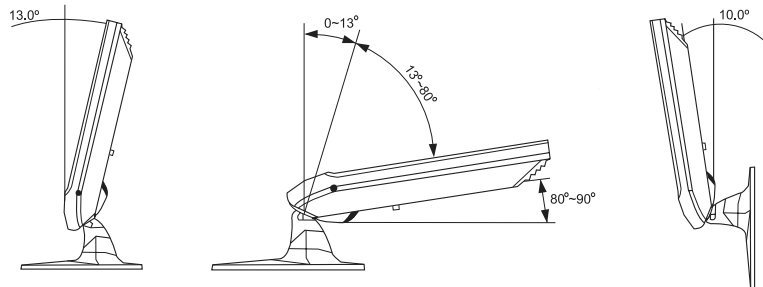

- 1** Picture (1) shows the adjustment angle (0°~ 13°) when you use LCD TV in its general form (stand-based LCD TV).  
Excessive tilting can turn LCD TV over which might cause damage to LCD TV.
- 2** Picture (2) shows the adjustment angle (13°~ 80°) when you convert stand-based LCD TV into wall-mounted one.
- 3** Picture (3) shows the adjustment angle (0°~ 10°) when you use wall-mounted LCD TV after fixing it to wall.

*Note : Picture (2) shows the angle adjustment section while LCD TV is being converted from stand-based one to wall-mounted one or vice versa.  
- Click\* sound indicates section change from 1 to 2 or 3 to 2 (1->2, 3->2).*

## APPENDIX

### Installing the Wall Mount Kit

Note : This installation is to be used when attaching the wall mount to a concrete wall.  
When attaching to other building materials, please contact your nearest dealer.

#### Components

Please use provided components or parts to install the Wall Mount Kit.

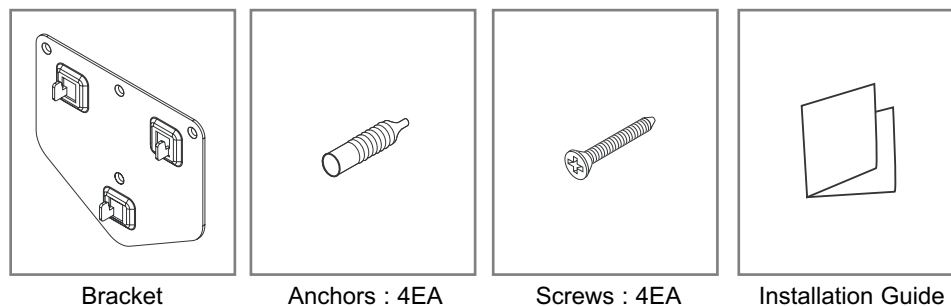

#### How to assemble the Wall Mount Kit

- 1
  - ① Mark the location of hole on the wall using installation guide.
  - ② Make over 35mm- depth- hole on the marked location using 5.0-diameter drill.
  - ③ Fix anchors on each hole on the wall.
  - ④ Connect bracket to the wall with screws after fitting anchors into the bracket holes.

*Note : If the bracket is not firmly fixed to the wall, LCD TV can fall off.*

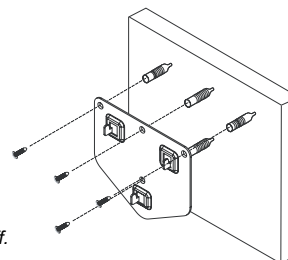

- 2 You may use LCD TV right after fixing it to the wall since stand is wrapped already turned over as shown in the picture

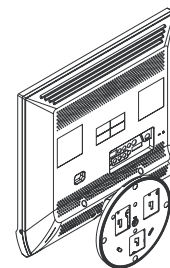

- 3 When using LCD TV in stand-based form, place the product on a cushion or other soft materials. Then turn over stand following the arrow direction below only after pressing button on the connected part where LCD TV is attached to stand. (Turn over stand in the opposite direction after pressing button when using LCD TV in wall-mounted form as well.)

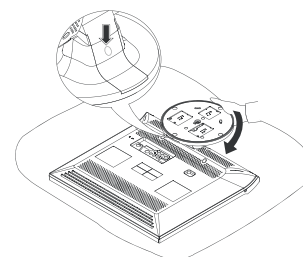

## APPENDIX

### Installing the Wall Mount Kit

- 4** Adjust LCD TV to the hook on the bracket and move in the direction of the arrow(Left) so that LCD TV can be completely fixed to the bracket.

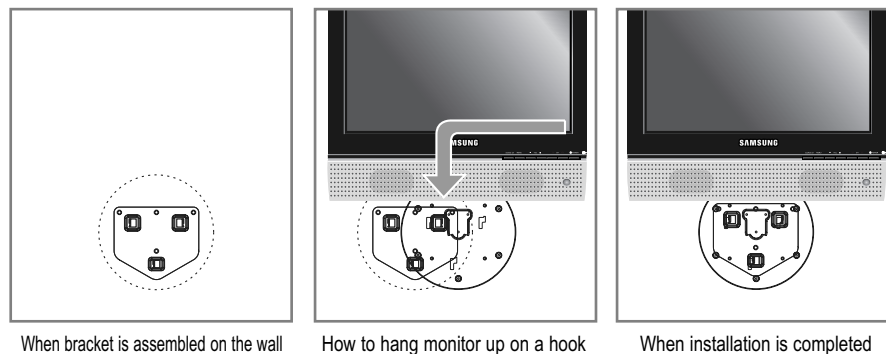

- 5** Remove Installation Guide after completing setup of LCD TV on the wall.
- 6** Push the LCD TV up and shift to the right to detach it from bracket.  
When moving or transferring to other areas, reverse No. 4 procedure so as to disconnect LCD TV with ease.

### How to adjust an angle

- (1) Angle adjustment section of general stand-based LCD TV
- (2) Angle adjustment section while converting the form (1->3, 3->1)
- (3) Angle adjustment section of wall-mounted LCD TV

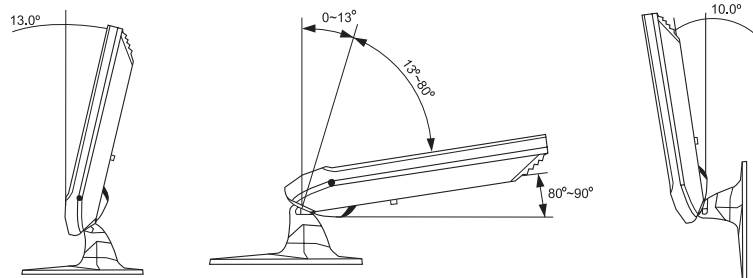

- 1** Picture (1) shows the adjustment angle (0°~ 13°) when you use LCD TV in its general form (stand-based LCD TV).  
Excessive tilting can turn LCD TV over which might cause damage to LCD TV.
- 2** Picture (2) shows the adjustment angle (13°~ 80°) when you convert stand-based LCD TV into wall-mounted one.
- 3** Picture (3) shows the adjustment angle (0°~ 10°) when you use wall-mounted LCD TV after fixing it to wall.

*Note : Picture (2) shows the angle adjustment section while LCD TV is being converted from stand-based one to wall-mounted one or vice versa.*